



CITY OF LANSING
Council Chambers
800 1st Terrace
Lansing, KS 66043

COUNCIL AGENDA
Regular Meeting
Thursday, December 7, 2017
7:00 P.M.

WELCOME TO YOUR CITY COUNCIL MEETING

Regular meetings are held on the first and third Thursday of each month at 7 pm and are televised on Cable Television Channel 2 on Monday 7 pm, Tuesday 10 am & 7 pm, Friday 5 pm, Saturday 1 pm and Sunday 7 pm.

Any person wishing to address the City Council, simply proceed to the microphone in front of the dais after the agenda item has been introduced and wait to be recognized by the Mayor. When called upon, please begin by stating your name and address. A time designated "Audience Participation" is listed on the agenda for any matter that does not appear on this agenda. The Mayor will call for audience participation. Please be aware that the city council and staff may not have had advance notice of your topic and that the city council may not be able to provide a decision at the meeting. If you require any special assistance, please notify the City Clerk prior to the meeting.

Call To Order

Pledge of Allegiance

Roll Call

OLD BUSINESS:

1. Approval of Minutes

NEW BUSINESS:

Audience Participation

Presentations

Council Consideration of Agenda Items:

2. Consent Calendar
 - a. Cereal Malt Beverage License Renewal – Petro Deli #2
 - b. Cereal Malt Beverage License Renewal – Shree Nivas Inc., dba Finish Line
 - c. Cereal Malt Beverage License Renewal – Truman Town dba Woody's Gas Express
 - d. Cereal Malt Beverage License Renewal – WKRP Management, LLC dba Pizza Hut
3. Renewal of Special Use Permit (125 Rock Creek Loop)
4. Renewal of Special Use Permit (128 E. Kansas)
5. Renewal of Special Use Permit (401 Fairlane)
6. Renewal of Special Use Permit (218 E. Kansas Street)
7. Request for Special Use Permit (224 Debra Street)
8. Parks & Recreation Advisory Board Appointments
9. Tree Board Appointment
10. Request for Special Event on Park Property – Boy Scouts
11. 2018 Court Services Contract
12. Ordinance No. 994 – Condemnation for DeSoto Road Project

Reports:

Department Heads: City Attorney; City Engineer; City Administrator; Councilmembers

Proclamations

Other Items of Interest:

13. Bernard Park Access Map

Adjournment



City of Lansing
800 First Terrace
Lansing, Kansas 66043

City Administrator's Report

December 7, 2017

Agenda Items:

Four cereal malt beverage license renewals are on the agenda for Thursday evening.

The renewal of four animal related special use permits is on the agenda, as well as one new request for a special use permit.

Parks & Recreation Advisory Board appointments are on the agenda for Thursday evening. Tree Board appointments are also included on the agenda.

A request for a special event on park property on behalf of the local Boy Scouts is on the agenda.

The 2018 Court Services contract with the City of Leavenworth is on the agenda for action on Thursday evening. In the past, this was overseen by Leavenworth County but the City of Leavenworth began overseeing the program last year, with positive results. The contract is identical to last year's contract.

Ordinance No. 994 authorizes the City to move forward with condemnation for DeSoto Road. We have had productive discussions with the property owners, but have struggled making contact with Bank of America.

Sales Tax Figures/Financials:

	2016 YTD	2017 YTD	Difference
Local Sales & Use Tax	\$862,606	\$904,451	\$41,845 (4.9%)
County Sales Tax	\$763,285	\$805,548	\$42,263 (5.5%)
County Use Tax	\$139,566	\$152,826	\$13,260 (9.5%)
Guest Tax	\$143,895	\$126,684	-\$17,211 (-11.9%)

The above numbers do not yet reflect the increase in sales tax from October 1, 2017. As a side note, we learned of one business in Lansing that was still charging the old sales tax rate as of mid-November. This business has since corrected the issue. As you frequent businesses in Lansing, please double check your receipt to ensure they are charging 8.95% in sales tax.

As the year winds down, I always enjoy looking at our budgeted figures, compared to our year to date actuals. There are still two pay periods remaining but spending typically slows down in December as we prepare to close our books for the year. Below is a table of some of our major funds, outlining how our expenses are shaping up compared to our budgeted figures:



City of Lansing
800 First Terrace
Lansing, Kansas 66043

	2017 Budgeted Exp.	2017 YTD Exp.	Remaining Balance
General Fund	\$5,899,705	\$5,062,220	\$837,485
Library Fund	\$299,695	\$251,023	\$48,672
Bond & Interest	\$2,902,010	\$2,884,976	\$17,033
Wastewater	\$2,630,272	\$2,250,003	\$380,269
Special Parks & Rec	\$161,700	\$155,050	\$6,650
Guest Tax Fund	\$159,974	\$119,396	\$40,578
Equip. Replacement	\$196,895	\$116,260	\$80,635
Special Highway	\$533,136	\$411,820	\$121,316

Public Works:

The initial condemnation hearing for the first tract was held at Leavenworth County District Court on November 29th. Selection of the three appraisers should be completed soon.

Public Works Director Jeff Rupp will brief the council on progress for the DeSoto Road project. Due to land acquisition delays, KDOT has delayed the bid letting date to March of 2018.

The County held their McIntyre Road informational meeting in the evening of November 29th. The meeting was productive and helped residents gain a better understanding of the construction process. We learned that installation of a box culvert near K7 will begin around December 4th. Crews are beginning this portion now because the installation of the box culvert is not dependent upon relocation of an existing water line. The City put out a press release to brief our citizens on this last week.

Parks & Recreation:

The City was approached by the new owner of property near Bernard Park about if we plan to utilize the property as a second access point. I have spoken with P&R Director Crum and City Attorney Robinson about this and we will brief the Council on Thursday evening to gauge our interest for a second access point, and what specifically that access point could be used for. A map of the area is attached.

Wastewater:

Survey field work was completed on November 27th for Master Plan Project #1. The 30% plans are due in December near the Christmas holiday. City staff has met with two major property owners affected by this project. This project will improve sewer capacity and hopefully spur further development in northwest Lansing. Much of the area is serviced by an 8" line.

Community & Economic Development:

The museum will be open on Friday's from 1pm-5pm, and by appointment. We have notified



City of Lansing
800 First Terrace
Lansing, Kansas 66043

the chair people of the Lansing Historical Society and KRPM, and have posted updated hours to our website and the museum's Facebook page. We are still planning on discussing a long term vision for the museum at our January 25th work session.

While we are without a C&ED Director, Chief Wayman will be overseeing code enforcement and I will be overseeing planning/zoning/economic development. If you have any questions or need assistance with something major, please feel free to contact me.

I will brief the council on some economic development prospects in executive session at the December 21st meeting.

Meetings & Announcements:

We currently have an opening on the Board of Zoning Appeals!

- Thursday, December 7 City Council Meeting, 7:00pm, City Hall
- Thursday, December 21 City Council Meeting, 7:00pm, City Hall
- Friday, December 22 Christmas Eve Holiday Observed, City Offices Close at Noon
- Monday, December 25 Christmas Holiday, City Offices Closed
- Monday, January 1 New Year's Day Holiday, City Offices Closed
- Thursday, January 4 City Council Meeting, 7:00pm, City Hall
- Thursday, January 18 City Council Meeting, 7:00pm, City Hall
- Thursday, January 25 City Council Work Session, 7:00pm, City Hall
(DH Residency Requirement, Museum Discussion)

Respectfully Submitted,

Tim Vandall

Leavenworth County, KS



Legend

- Address Point
- Parcel
- Parcel Number
- Subdivisions
- Lot Line
- Plat Block Number
- City Limit Line
- Major Road
- <all other values>
- 70
- Road
- + Railroad
- Section
- Section Boundaries
- County Boundary

1 in. = 218ft.

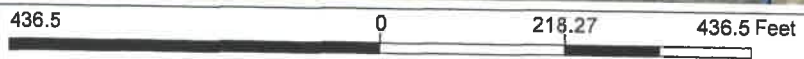

This Cadastral Map is for informational purposes only. It does not purport to represent a property boundary survey of the parcels shown and shall not be used for conveyances or the establishment of property boundaries.
 THIS MAP IS NOT TO BE USED FOR NAVIGATION

Notes